

FIRST TIME INSTALLATION

- Please read instructions carefully before installation.
- Check the contents of kit. Contact your YAKIMA dealer if any parts appear missing or damaged.
- Clean your Platform prior to fitting the LOCKN'LOAD Jerry Can Holder.
- Place these instructions in the vehicle's glove box after installation is complete.

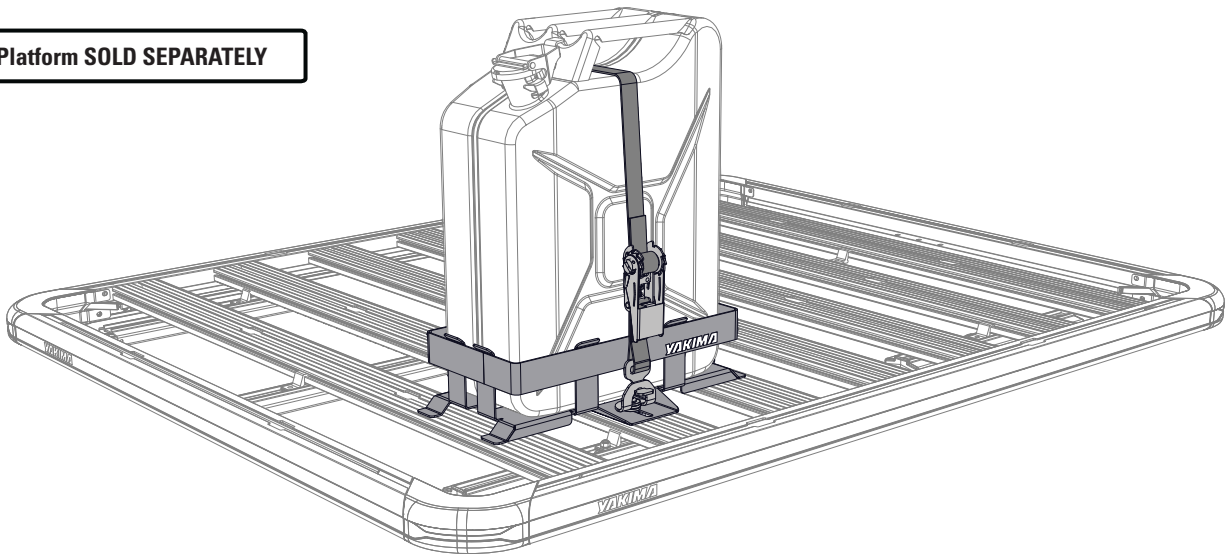

Platform SOLD SEPARATELY



KIT CONTENTS

ITEM	COMPONENT	QTY
1.	Jerry Can Holder	x1
2.	Ratchet Strap	x1
3.	Loose Strap	x1
4.	Allen Key 5 mm	x1
5.	Swivel Anchor	x2
6.	Swivel Spacer	x2
7.	Thrust Washer	x4
8.	Buttonhead Capscrew M8x25	x2
9.	Wave Washer	x2
10.	Spring Nut M8	x2

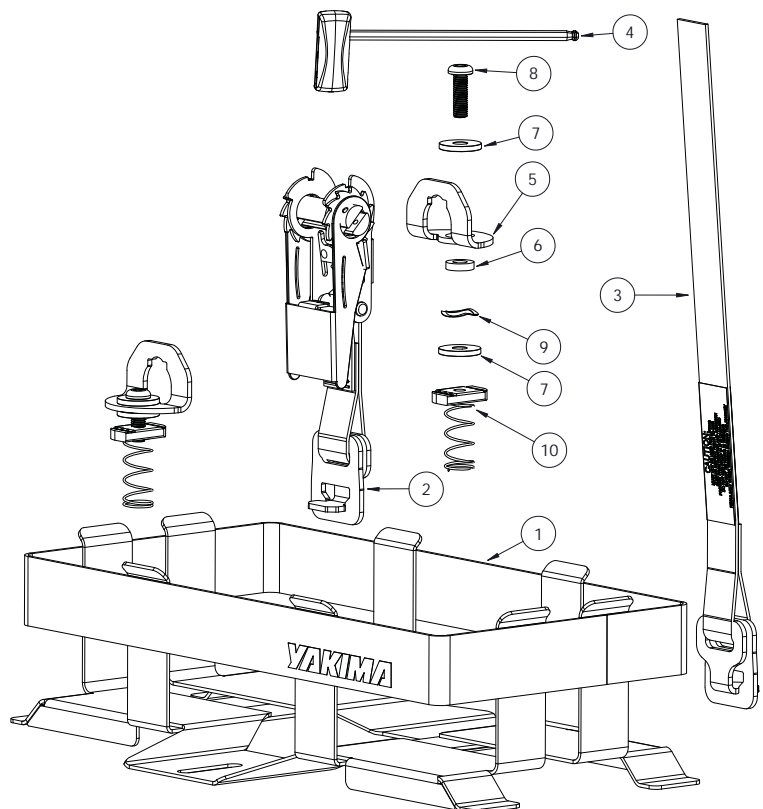

INSTALLATION

INSTALLATION LOCATIONS

The Jerry Can Holder is best located near the perimeter of the Platform and across three slats where possible. All four corners of the Jerry Can need to be supported by a Platform slat or rail.

Installing the Jerry Can Holder in the center of the Platform is not recommended due to the flexing of the slats. It is recommended that no more than two Jerry Cans are stored on the roof.

Storing items such as full Jerry Cans raises the center of gravity of the vehicle and this effects the handling of the vehicle.

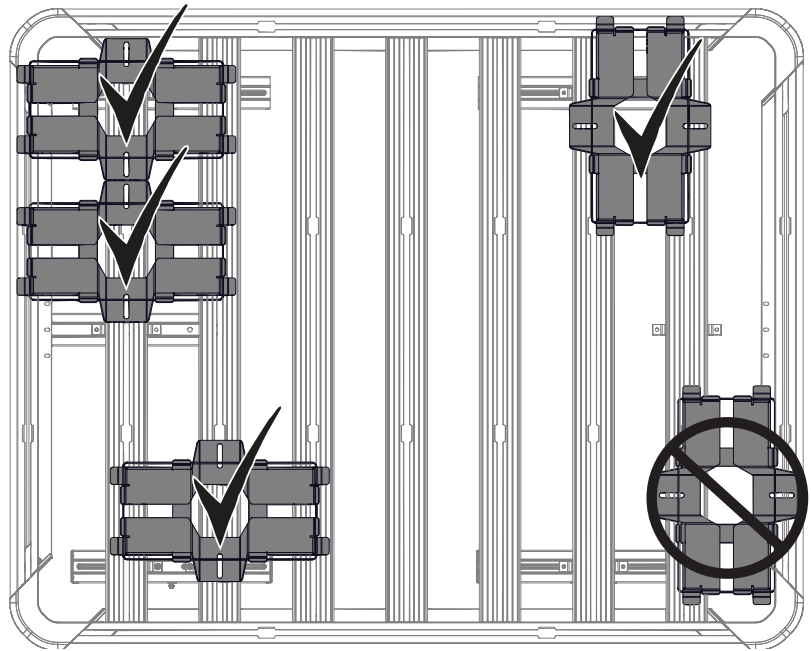

1

INSERT SPRING NUTS

Based on the recommended Installation Locations, determine where on the Platform you wish to install the Jerry Can Holder.

Insert 2x Spring Nuts into closest slat channel cut out.

The Spring Nuts do not need to be rotated into place.

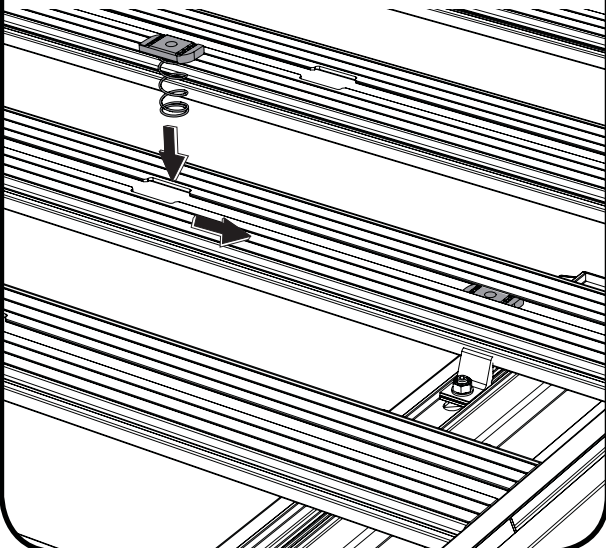

HARDWARE ASSEMBLY ORDER



Buttonhead Capscrew M8x25



Thrust Washer



Swivel Spacer

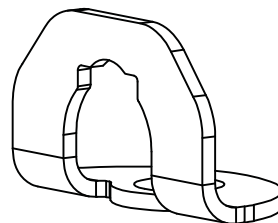

Swivel Anchor



Wave Washer



Thrust Washer

2**INSTALL JERRY CAN ASSEMBLY**

Align slots on Jerry Can Holder with the Spring Nuts in Platform Slat channel.

Secure the Swivel Anchor to Platform using the following components in the order shown:

- Thrust Washer
- Wave Washer
- Swivel Spacer
- Lifting Lug Thrust Washer
- Buttonhead Capscrew

Tighten Capscrews to 7 Nm using the Allen Key provided.

NOTE: Ensure Wave Washer is not is not pinched by Swivel Spacer. A screwdriver can be used to adjust if necessary.

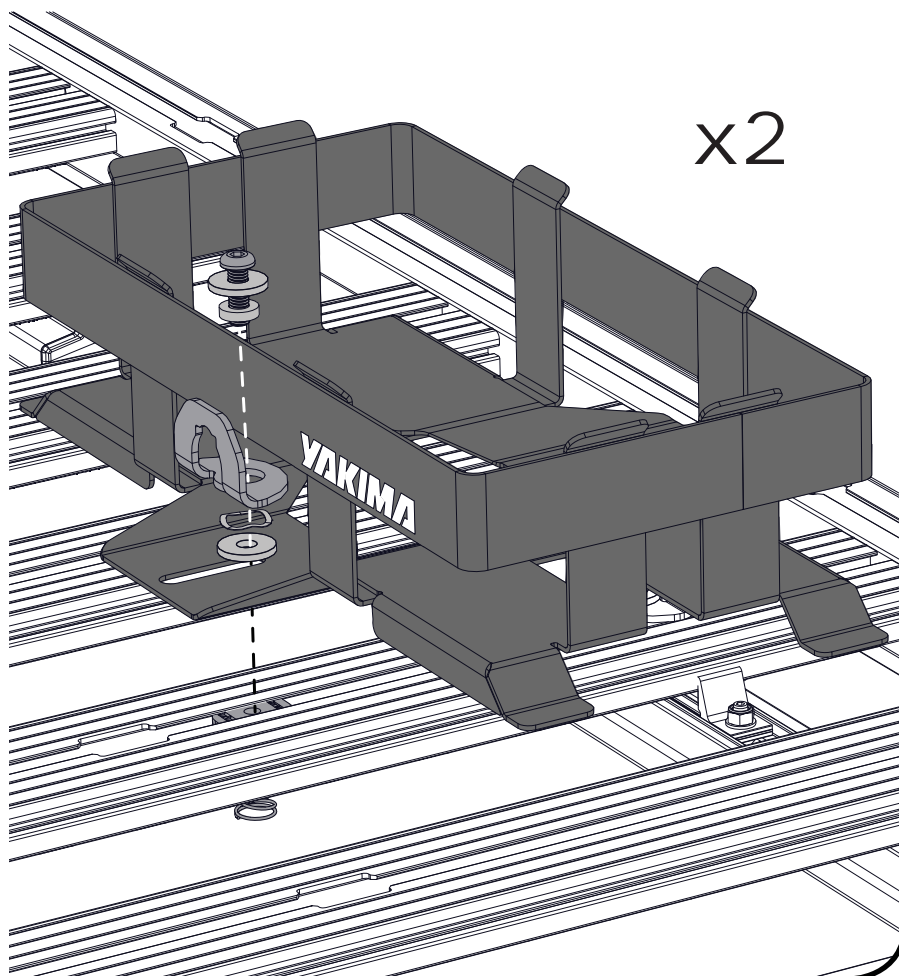
**3****INSTALL JERRY CAN**

Install Jerry Can into the secured Jerry Can Holder with the spout upright.

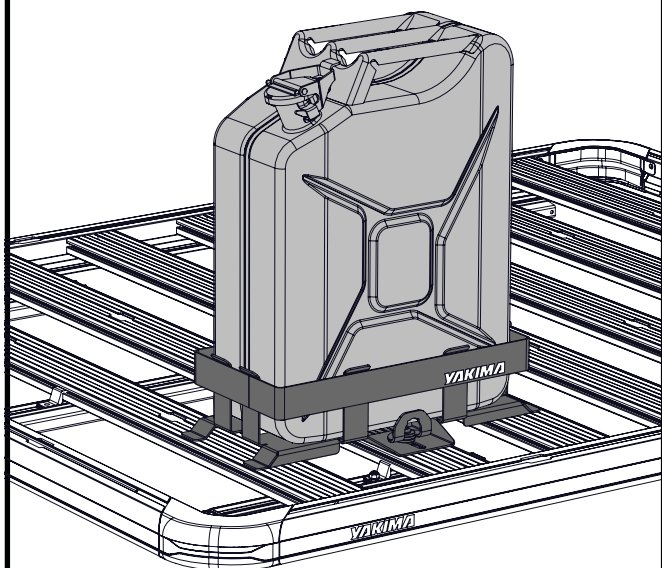
**4****SECURE LATCH**

Feed Loose Strap through Jerry Can handle and hook latch through Swivel Anchor from behind.

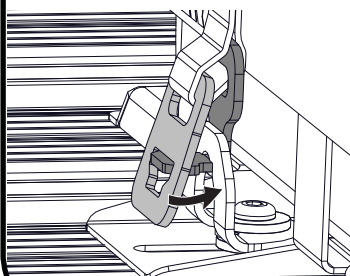
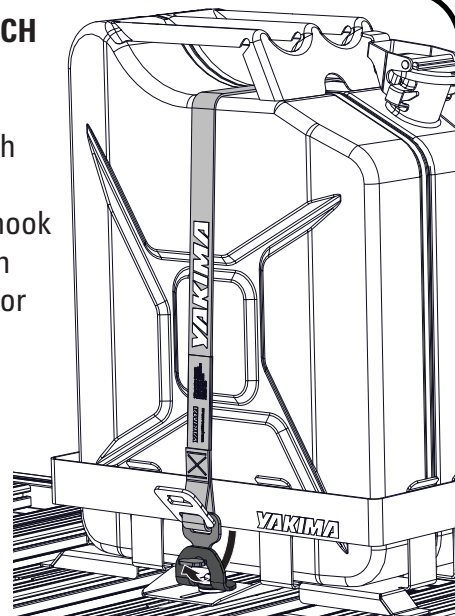
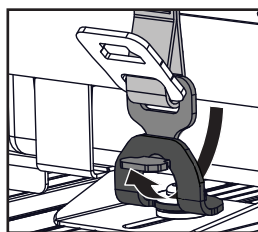

Flip other latch over first latch to lock in place.

5**SECURE RATCHET**

Feed the unhooked end of the Strap through the Ratchet. Hook latch through Swivel Anchor from behind.

Lever the Ratchet Barrel through at least two turns to secure Strap, then lever until tight.

Flip other latch over first latch to lock in place.

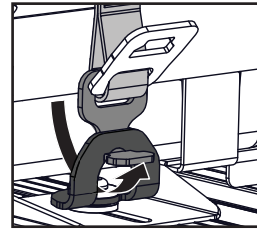
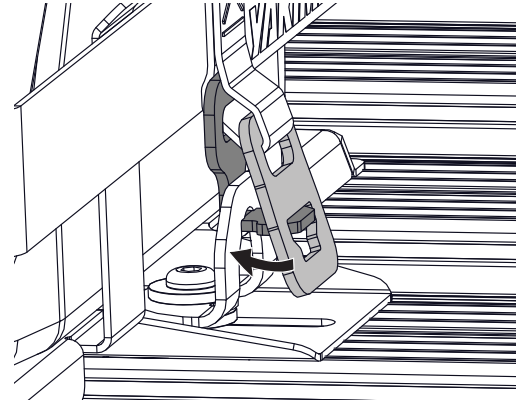
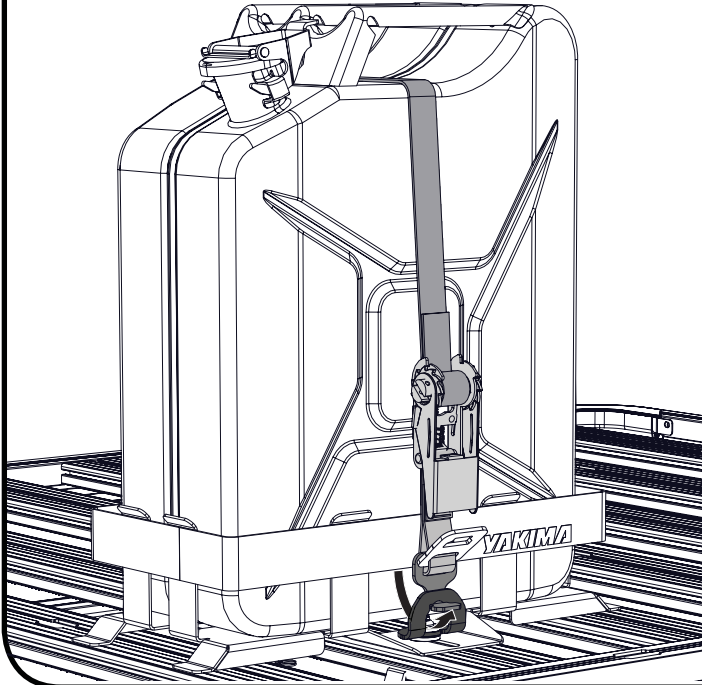
**MAINTENANCE AND SAFETY**

- If straps become contaminated with oil, fuel or acid remove with hot soapy water.
- If the ratchet mechanism becomes stiff in use, a small amount of lubrication applied to the moving parts will ease operation.
- Ratchet strap must not be used for lifting. Protect from abrasion and friction. Do not tie knots in the straps. Do not use a damaged strap.
- 150kg lashing capacity on the polypropylene webbing.

YAKIMAwww.yakima.com.au**YAKIMA AUSTRALIA PTY. LTD**

17 Hinkler Court
Brendale, QLD 4500
Australia
1800 143 548

YAKIMA EUROPE COÖPERATIEF U.A.

Twentehaven 7, 3433
PT Nieuwegein
The Netherlands
+31 2080 81425

YAKIMA PRODUCTS, INC.

4101 Kruse Way
Lake Oswego, OR
97035-2541
USA
888 925 4621