

**AU & NZ Fitting**

**Flat connectors comply with Australian Standard AS4177.5-2004.**

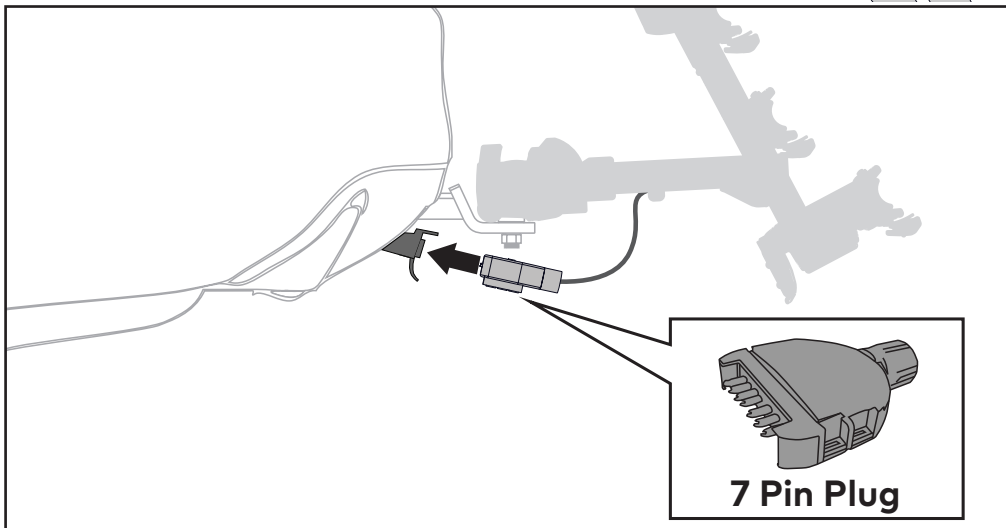
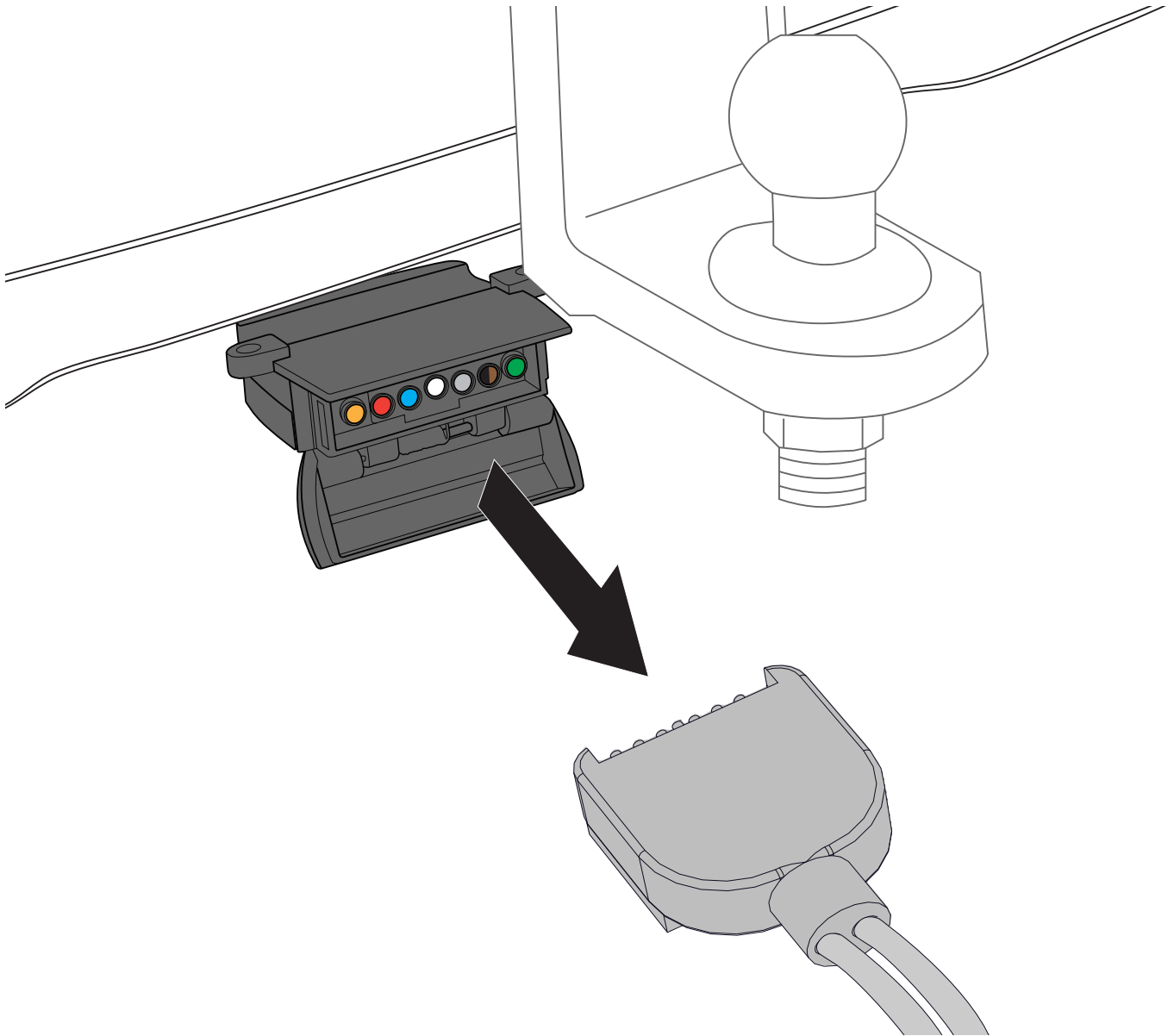

**7 Pin Plug**

Pin Number	Wire Colour	Circuit	Note
4	Green	Right-Hand turn	
7	Brown and Black	Rear Lamps, Clearance And Side Marker Lamps	
2	Grey	Reversing Signal	Must be disconnected or changed by an auto electrician if the vehicle is currently wired for constant 12V power at this pin (i.e. reverse lights always on).
3	White	Earth Return	
5	Blue	Service Brakes	N/A to FoldClick/JustClick
6	Red	Stop Lamps	
1	Yellow	Left-Hand Turn	

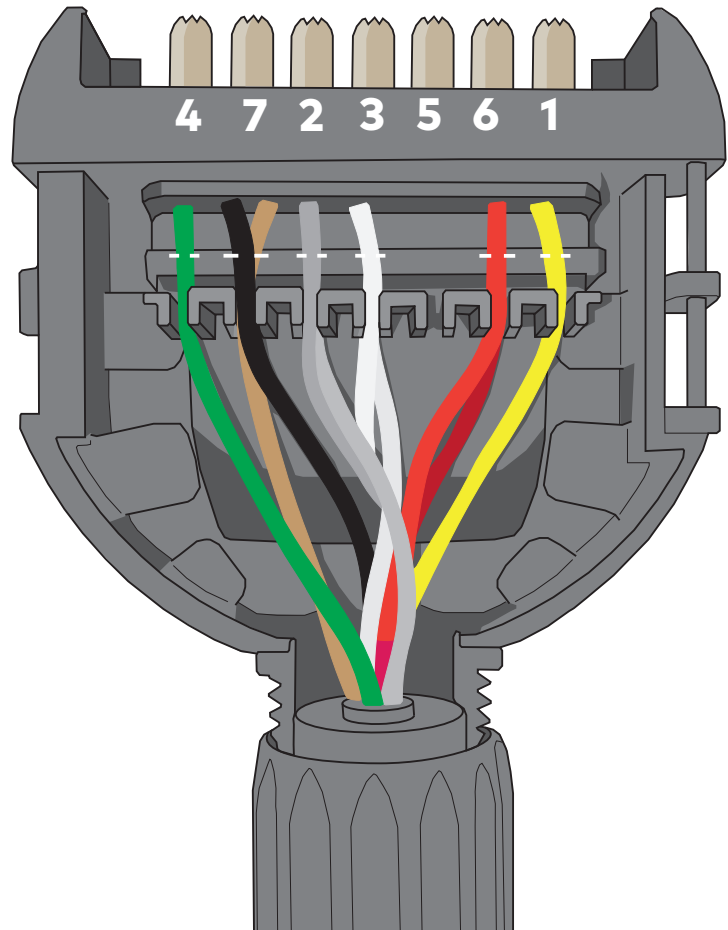

### Cable Entry View



**7 Pin Plug**



**7 Pin Socket**

**YAKIMA**

[www.yakima.com.au](http://www.yakima.com.au)

[www.yakima.co.nz](http://www.yakima.co.nz)

[www.yakima.com](http://www.yakima.com)

[www.yakima.eu](http://www.yakima.eu)

**YAKIMA AUSTRALIA PTY LTD**

17 Hinkler Court  
Brendale, QLD 4500  
Australia  
1800 143 548

**YAKIMA PRODUCTS, INC.**

4101 Kruse Way  
Lake Oswego, OR  
97035-2541  
USA  
888 925 4621

**ALL CONTENT SUBJECT TO YAKIMA AUSTRALIA PTY LTD COPYRIGHT © 2022**